

# ROTARY - STANDARD

DESCRIPTION	LIST PRICE	PART NUMBER	TYPE
<b>BMRX POWER PACS</b>			
BMRX - 115 VAC - Rotary level indicator power pac featuring a triple-thread, screw-off cover, dual conduit entries, DPDT relay contacts, selectable fail-safe protection, FDA recognized powder coat finish, hazardous location approval, and C/US listed for Class I, Groups C & D and Class II, Groups E, F & G.	Call for price	730-0504 730-0504-EX 730-0569	Standard ATEX Process Connection
BMRX - 230 VAC - Rotary level indicator power pac featuring a triple-thread, screw-off cover, dual conduit entries, DPDT relay contacts, selectable fail-safe protection, FDA recognized powder coat finish, hazardous location approval, and C/US listed for Class I, Groups C & D and Class II, Groups E, F & G.	Call for price	730-0503 730-0503-EX 730-0570	Standard ATEX Process Connection
BMRX - 24 VAC - Rotary level indicator 24 VAC with dual conduit entries, DPDT relay contacts, selectable fail-safe protection, and FDA recognized powder coat finish, hazardous location approval, and C/US listed for Class I, Groups C & D and Class II, Groups E, F & G.	Call for price	730-0505 730-0505-EX	Standard ATEX
BMRX - 24 VDC - Rotary level indicator 12 to 24 VDC with dual conduit entries, DPDT relay contacts, selectable fail-safe protection, and FDA recognized powder coat finish, hazardous location approval, and C/US listed for Class I, Groups C & D and Class II, Groups E, F & G.	Call for price	730-0661 730-0661-EX 730-0664	Standard ATEX Process Connection
<b>MAXIMA+ POWER PACS</b>			
MAXIMA+ 24/115/230 VAC - Fail-safe rotary level indicator power pac with hazardous location approval, C/US listed for Class II, Groups E, F, & G and a visual LED status light monitoring paddle rotation, paddle covered, and fault conditions. Features a triple-thread, screw-off cover, dual conduit entries, DPDT relay contacts, fail-safe protection, SPDT normal and fault relay contact and FDA recognized powder coat finish.	Call for price	730-0528 730-0528-EX 730-0574	Standard ATEX Process Connection
MAXIMA+ 12-24 VDC - Fail-safe rotary level indicator power pac with hazardous location approval, C/US listed for Class II, Groups E, F, & G and a visual LED status light monitoring paddle rotation, paddle covered, and fault conditions. Features a triple-thread, screw-off cover, dual conduit entries, DPDT relay contacts, fail-safe protection, SPDT normal and fault relay contact and FDA recognized powder coat finish.	Call for price	730-0662 730-0662-EX 730-0665	Standard ATEX Process Connection

1: Standard  
2: ATEX  
3: Process Connection

# ROTARY - STANDARD

DESCRIPTION	LIST PRICE	PART NUMBER	NOTES
<b>FITTINGS</b>			
GRPC-1 - 1-1/4" Stainless steel process connection fitting & o-ring for 1" coupled pipe guards	Call for price	416-0507	1, 2
GRPC-2 - 1-1/2" Stainless steel process connection fitting & o-ring for 1" coupled pipe guards	Call for price	416-0508	1, 2
GRPC-3 - 1-1/4" Aluminum process connection fitting & o-ring for 1" coupled pipe guards	Call for price	416-0505	1, 2
GRPC-4 - 1-1/2" Aluminum process connection fitting & o-ring for 1" coupled pipe guards	Call for price	416-0506	1, 2
SSPC-1 - 1-1/4" NPT Stainless steel process connection with bearing and seal	Call for price	416-0547	3
SSPC-2 - 1-1/2" NPT Stainless steel process connection with bearing and seal	Call for price	416-0548	3
SSPC-3 - 1-1/4" NPT Stainless steel process connection with bearing and seal, includes teflon bearing and grease packed bearings to provide additional corrosion resistance	Call for price	416-0736	3
<b>COUPLINGS</b>			
GRSS-1 - Solid shaft, stainless steel side mount coupler	Call for price	299-0004	1, 2, 3
GRFC-1 - Flexible stainless steel top mount coupler	Call for price	416-0155	1, 2
GRFS-1 - Molded neoprene, flexible shaft, stainless steel top mount coupler	Call for price	416-0283	1, 2
BSA - Bindicator stainless steel shaft adapter, to couple BinMaster rotary PowerPac to a Bindicator shaft coupler or Bindicator Paddle.	Call for price	416-0294	1, 2, 3
<b>MOUNTING PLATES</b>			
GRMP-1 - 0° Mild carbon steel half coupling 1.25" with black neoprene gasket	Call for price	730-0020	1, 2, 3
GRMP-2 - GRMP-2 - 0° Mild carbon steel full coupling 1.25", powder coated with black neoprene gasket	Call for price	730-0022	1, 2, 3
GRMP-3 - 0° Stainless steel half coupling 1.25" mounting plate with black neoprene gasket	Call for price	730-0021	1, 2, 3
GRMP-4 - 0° Stainless steel full coupling 1.25" with black neoprene gasket	Call for price	730-0023	1, 2, 3
GRMP-9 - 10° Mild carbon steel full coupling 1.25", powder coated with black neoprene gasket	Call for price	730-0489	1, 2, 3
GRMP-13 - 30° Mild carbon steel full coupling 1.25", powder coated with black neoprene gasket	Call for price	730-0508	1, 2, 3
GRMP-14 - 0° Mild carbon steel half coupling 1.25" with white silicone gasket	Call for price	730-0567	1, 2, 3
GRMP-15 - 0° Stainless steel full coupling 1.25" with white silicone gasket	Call for price	730-0568	1, 2, 3
GRMP-16 - 20° Mild carbon steel full coupling 1.25", powder coated with black neoprene gasket	Call for price	730-0663	1, 2, 3

1: Standard

2: ATEX

3: Process Connection

# ROTARY - STANDARD

DESCRIPTION	LIST PRICE	PART NUMBER	NOTES
<b>PADDLES</b>			
GRP-1 - Triple-bladed, stainless steel paddle for light weight materials, paddle turns in a 7" diameter, blades are 2" wide	Call for price	416-0161	1, 2, 3
GRP-2 - Triple-bladed, stainless steel paddle for average weight materials, paddle turns in a 5" diameter, blades are 1-1/2" wide	Call for price	416-0152	1, 2, 3
GRP-3 - Single-blade, stainless steel paddle for average to heavy weight materials, paddle is 2-1/2" long and turns in a 5" diameter, insertable paddle blade is 1/8" thick and 1" wide	Call for price	416-0153	1, 2, 3
GRP-11 - High strength nylon paddle for lightweight materials, triple-bladed paddle turns in a 7" diameter, blades are 2" wide	Call for price	299-0009	1, 2, 3
GRP-12 - High strength nylon paddle for average weight materials, triple-bladed paddle turns in a 5" diameter, blades are 1.5" wide	Call for price	299-0010	1, 2, 3
GRP-22 - Triple-bladed, stainless steel paddle for average to heavy weight materials, turns in a 5" diameter, paddle blades are 1/8" thick and 1" wide	Call for price	416-0160	1, 2, 3
GRP-23 - Single bayonet blade, stainless steel paddle for high level control in light and medium materials and low level control in light materials, insertable paddle blade is 1/8" thick and 1" wide	Call for price	416-0154	1, 2, 3
GRP-24 - 12" Belt paddle for high level control in heavy materials with large particle size	Call for price	416-0259	1, 2, 3
GRP-25 - Triple-bladed, stainless steel paddle for very light materials, paddle turns in a 5" diameter, blades are 5" tall and 1/16" thick	Call for price	416-0261	1, 2, 3
GRP-26 - Triple-bladed, stainless steel paddle for light weight materials, paddle turns in a 7" diameter, blades are 2" wide, direct connect paddle that eliminates the need for GRSS-1 coupler	Call for price	416-0265	1, 2, 3
GRP-27 - Single bayonet blade, stainless steel paddle for high level control in light and medium materials and low level control in light materials, insertable paddle blade is 1/8" thick and 1" wide, direct connect paddle that eliminates the need for GRSS-1 coupler	Call for price	416-0266	1, 2, 3
GRP-28 - Triple-bladed, stainless steel paddle for extremely light materials, paddle turns in a 7" diameter, blades are 5" tall and 1/16" thick	Call for price	416-0336	1, 2, 3
GRP-29 - Triple-bladed, stainless steel paddle for very light materials, paddle turns in a 5" diameter, blades are 5" tall and 1/16" thick, direct connect paddle that eliminates the need for GRSS-1 coupler	Call for price	416-0430	1, 2, 3
GRP-30 - Triple-bladed, stainless steel paddle for average weight materials, paddle turns in a 5" diameter, blades are 1-1/2" wide, direct connect paddle that eliminates the need for GRSS-1 coupler	Call for price	416-0100	1, 2, 3
GRP-31 - Single-bladed, stainless steel paddle for medium to heavy materials, paddle turns in a 6.5" diameter, blade is 3.25" long, 1.63" wide and 1/8" thick	Call for price	416-0487	1, 2, 3
GRP-34 - Folding, single-bladed, insertable paddle for medium materials will fold to insert through a 1-1/4" or 1-1/2" process connection, turns in a 7.5" diameter, blades are 1-1/2" wide, direct connect paddle that eliminates the need for GRSS-1 coupler	Call for price	416-0513	1, 2, 3
GRP-35 - Folding, double-bladed, insertable paddle for medium materials will fold to insert through a 1-1/4" or 1-1/2" process connection, turns in a 7.5" diameter, blades are 1-1/2" wide, direct connect paddle that eliminates the need for GRSS-1 coupler	Call for price	416-0514	1, 2, 3
GRP-36 - Threaded, folding, single-bladed, insertable paddle for medium materials will fold to insert through a 1-1/4" or 1-1/2" process connection, turns in a 7.5" diameter, blades are 1-1/2" wide, for use with standard threaded coupler	Call for price	416-0556	1, 2, 3
GRP-37 - Threaded, folding, double-bladed, insertable paddle for medium materials will fold to insert through a 1-1/4" or 1-1/2" process connection, turns in a 7.5" diameter, blades are 1-1/2" wide, for use with standard threaded coupler	Call for price	416-0557	1, 2, 3

1: Standard

2: ATEX

3: Process Connection

# ROTARY - STANDARD

DESCRIPTION	LIST PRICE	PART NUMBER	NOTES
<b>SHAFT EXTENSIONS</b>			
<i>Galvanized</i>			
6" x 1/4"Ø Galvanized shaft extension, includes paddle coupling	Call for price	299-0407	1, 2
12" x 1/4"Ø Galvanized shaft extension, includes paddle coupling	Call for price	299-0408	1, 2
15" x 1/4"Ø Galvanized shaft extension, includes paddle coupling	Call for price	299-0907	1, 2
18" x 1/4"Ø Galvanized shaft extension, includes paddle coupling	Call for price	299-0409	1, 2
24" x 1/4"Ø Galvanized shaft extension, includes paddle coupling	Call for price	299-0410	1, 2
30" x 1/4"Ø Galvanized shaft extension, includes paddle coupling	Call for price	299-0682	1, 2
36" x 1/4"Ø Galvanized shaft extension, includes paddle coupling	Call for price	299-0411	1, 2
48" x 1/4"Ø Galvanized shaft extension, includes paddle coupling	Call for price	299-0412	1, 2
60" x 1/4"Ø Galvanized shaft extension, includes paddle coupling	Call for price	299-0609	1, 2
63" x 1/4"Ø Galvanized shaft extension, includes paddle coupling	Call for price	299-0610	1, 2
72" x 1/4"Ø Galvanized shaft extension, includes paddle coupling	Call for price	299-0611	1, 2
84" x 1/4"Ø Galvanized shaft extension, includes paddle coupling	Call for price	299-0612	1, 2
XX x 1/4"Ø Custom Galvanized shaft extension, includes paddle coupling*	Call for price	999-1000-XX	1, 2
<i>Stainless Steel</i>			
6" x 1/4"Ø Stainless steel shaft extension, includes paddle coupling	Call for price	299-0413	1, 2
12" x 1/4"Ø Stainless steel shaft extension, includes paddle coupling	Call for price	299-0414	1, 2
15" x 1/4"Ø Stainless steel shaft extension, includes paddle coupling	Call for price	299-0908	1, 2
18" x 1/4"Ø Stainless steel shaft extension, includes paddle coupling	Call for price	299-0415	1, 2
24" x 1/4"Ø Stainless steel shaft extension, includes paddle coupling	Call for price	299-0416	1, 2
30" x 1/4"Ø Stainless steel shaft extension, includes paddle coupling	Call for price	299-0735	1, 2
36" x 1/4"Ø Stainless steel shaft extension, includes paddle coupling	Call for price	299-0417	1, 2
48" x 1/4"Ø Stainless steel shaft extension, includes paddle coupling	Call for price	299-0418	1, 2
60" x 1/4"Ø Stainless steel shaft extension, includes paddle coupling	Call for price	299-0634	1, 2
72" x 1/4"Ø Stainless steel shaft extension, includes paddle coupling	Call for price	299-0636	1, 2
84" x 1/4"Ø Stainless steel shaft extension, includes paddle coupling	Call for price	299-0637	1, 2
XX x 1/4"Ø Custom Stainless steel shaft extension, includes paddle coupling*	Call for price	999-1001-XX	1, 2
<b>SHAFT GUARDS</b>			
<i>1-1/4" Galvanized</i>			
6" x 1-1/4" Diameter Galvanized shaft guard	Call for price	299-0909	1, 2
12" x 1-1/4" Diameter Galvanized shaft guard	Call for price	299-0910	1, 2
15" x 1-1/4" Diameter Galvanized shaft guard	Call for price	299-0911	1, 2
18" x 1-1/4" Diameter Galvanized shaft guard	Call for price	299-0681	1, 2
24" x 1-1/4" Diameter Galvanized shaft guard	Call for price	299-0419	1, 2
30" x 1-1/4" Diameter Galvanized shaft guard	Call for price	299-0736	1, 2
36" x 1-1/4" Diameter Galvanized shaft guard	Call for price	299-0420	1, 2
48" x 1-1/4" Diameter Galvanized shaft guard	Call for price	299-0421	1, 2

1: Standard  
2: ATEX  
3: Process Connection

\* \$25 Minimum on Custom Guard or Shaft Lengths

# ROTARY - STANDARD

DESCRIPTION	LIST PRICE	PART NUMBER	NOTES
<b>SHAFT GUARDS</b>			
<i>1-1/4" Galvanized</i>			
60" x 1-1/4" Diameter Galvanized shaft guard	Call for price	299-0613	1, 2
63" x 1-1/4" Diameter Galvanized shaft guard	Call for price	299-0614	1, 2
72" x 1-1/4" Diameter Galvanized shaft guard	Call for price	299-0615	1, 2
84" x 1-1/4" Diameter Galvanized shaft guard	Call for price	299-0616	1, 2
XX x 1-1/4" Custom Diameter Galvanized shaft guard*	Call for price	999-1002-XX	1, 2
<b>SHAFT GUARDS</b>			
<i>1-1/4" Stainless Steel</i>			
6" x 1-1/4" Diameter Stainless steel shaft guard	Call for price	299-0912	1, 2
12" x 1-1/4" Diameter Stainless steel shaft guard	Call for price	299-0913	1, 2
15" x 1-1/4" Diameter Stainless steel shaft guard	Call for price	299-0914	1, 2
18" x 1-1/4" Diameter Stainless steel shaft guard	Call for price	299-0737	1, 2
24" x 1-1/4" Diameter Stainless steel shaft guard	Call for price	299-0422	1, 2
30" x 1-1/4" Diameter Stainless steel shaft guard	Call for price	299-0738	1, 2
36" x 1-1/4" Diameter Stainless steel shaft guard	Call for price	299-0423	1, 2
48" x 1-1/4" Diameter Stainless steel shaft guard	Call for price	299-0424	1, 2
60" x 1-1/4" Diameter Stainless steel shaft guard	Call for price	299-0638	1, 2
63" x 1-1/4" Diameter Stainless steel shaft guard	Call for price	299-0639	1, 2
72" x 1-1/4" Diameter Stainless steel shaft guard	Call for price	299-0640	1, 2
84" x 1-1/4" Diameter Stainless steel shaft guard	Call for price	299-0641	1, 2
XX x 1-1/4" Custom Diameter Stainless steel shaft guard*	Call for price	999-1003-XX	1, 2
<i>1" Galvanized</i>			
4" x 1" Diameter Galvanized shaft guard	Call for price	299-0915	1, 2
6" x 1" Diameter Galvanized shaft guard	Call for price	299-0916	1, 2
8" x 1" Diameter Galvanized shaft guard	Call for price	299-0917	1, 2
10" x 1" Diameter Galvanized shaft guard	Call for price	299-0918	1, 2
12" x 1" Diameter Galvanized shaft guard	Call for price	299-0919	1, 2
15" x 1" Diameter Galvanized shaft guard	Call for price	299-0920	1, 2
18" x 1" Diameter Galvanized shaft guard	Call for price	299-0921	1, 2
24" x 1" Diameter Galvanized shaft guard	Call for price	299-0922	1, 2
30" x 1" Diameter Galvanized shaft guard	Call for price	299-0923	1, 2
36" x 1" Diameter Galvanized shaft guard	Call for price	299-0924	1, 2
48" x 1" Diameter Galvanized shaft guard	Call for price	299-0925	1, 2
60" x 1" Diameter Galvanized shaft guard	Call for price	299-0926	1, 2
72" x 1" Diameter Galvanized shaft guard	Call for price	299-0927	1, 2
XX x 1" Custom Diameter Galvanized shaft guard*	Call for price	299-0928-XX	1, 2

1: Standard  
2: ATEX  
3: Process Connection

\* \$25 Minimum on Custom Guard or Shaft Lengths

# ROTARY - STANDARD

DESCRIPTION	LIST PRICE	PART NUMBER	NOTES
<b>SHAFT GUARDS</b>			
<i>1" Stainless Steel</i>			
6" x 1" Diameter Stainless steel shaft guard	Call for price	299-0760	1, 2
12" x 1" Diameter Stainless steel shaft guard	Call for price	299-0761	1, 2
15" x 1" Diameter Stainless steel shaft guard	Call for price	299-0762	1, 2
18" x 1" Diameter Stainless steel shaft guard	Call for price	299-0763	1, 2
24" x 1" Diameter Stainless steel shaft guard	Call for price	299-0764	1, 2
30" x 1" Diameter Stainless steel shaft guard	Call for price	299-0765	1, 2
36" x 1" Diameter Stainless steel shaft guard	Call for price	299-0766	1, 2
48" x 1" Diameter Stainless steel shaft guard	Call for price	299-0767	1, 2
60" x 1" Diameter Stainless steel shaft guard	Call for price	299-0768	1, 2
72" x 1" Diameter Stainless steel shaft guard	Call for price	299-0769	1, 2
XX x 1" Custom Diameter Stainless steel shaft guard*	Call for price	299-0929-XX	1, 2
<b>ACCESSORIES</b>			
Rotary fitting to allow 1" guard pipe extensions to be adjusted for variable insertion lengths. The fitting threads into BinMaster 1 1/4" mounting plate and has set screws to allow variable height adjustments.	Call for price	416-0641	1, 2
1-1/4" Galvanized NPT female coupler to attach guard pipes together	Call for price	201-9010	1, 2
1-1/4" Stainless steel NPT female coupler to attach guard pipes together	Call for price	201-9033	1, 2
1" Aluminum NPT female coupler to attach guard pipes together	Call for price	201-9034	1, 2
1" Stainless steel NPT female coupler to attach guard pipes together	Call for price	201-9035	1, 2
1/4" Galvanized NPT female coupler to attach paddle to shaft extensions or shaft extensions together	Call for price	201-9028	1, 2
1/4" SS NPT female coupler to attach paddle to shaft extensions or shaft extensions together	Call for price	201-9029	1, 2
1/4" Aluminum NPT female coupler to attach paddle to shaft extensions or shaft extensions together	Call for price	201-9036	1, 2

**1: Standard**  
**2: ATEX**  
**3: Process Connection**

\* \$25 Minimum on Custom Guard or Shaft Lengths



# ROTARY

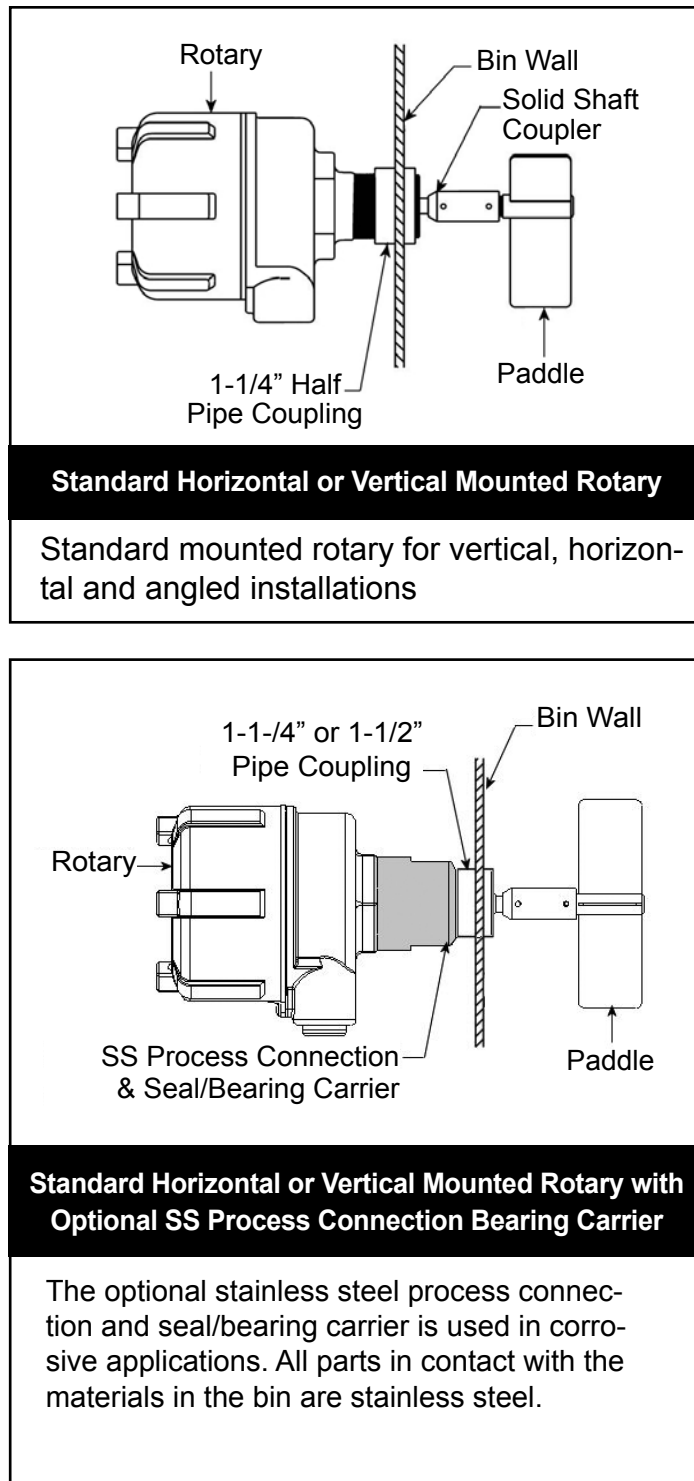
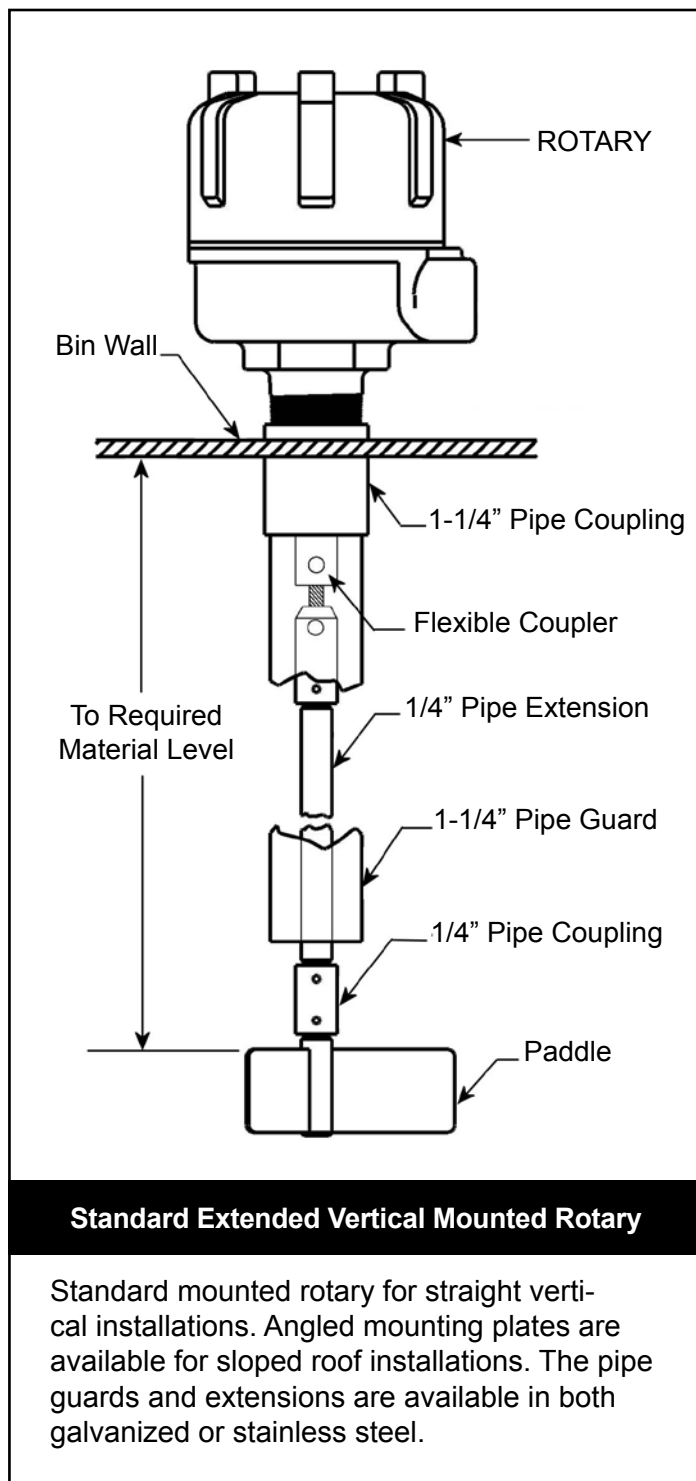

# ROTARY

## Paddle Assemblies

### GRP-1

Stainless steel for light materials, 3-vane paddle, turns in 7" diameter.

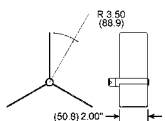

### GRP-2

Stainless steel for medium materials, 3-vane paddle, turns in 5" diameter.

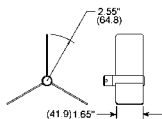

### GRP-3

Stainless steel for heavy materials, single vane, turns in 5" diameter, insertable through a 1-1/4" or 1-1/2" NPT opening.

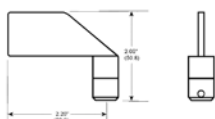

### GRP-11

Economical nylon paddle for light materials, 3-vane paddle, turns in 7" diameter.

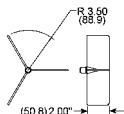

### GRP-12

Economical nylon paddle for medium materials 3-vane paddle, turns in 5" diameter.

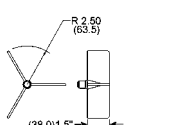

### GRP-22

Stainless steel for heavy materials, 3-vane paddle, turns in 5" diameter.

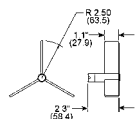

### GRP-23

Stainless steel single bayonet style paddle, turns in 5" diameter. Insertable through a 1-1/4" or 1-1/2" NPT opening.

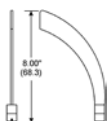

### GRP-24

12" belt paddle for use in heavy material with large particulate size such as rock, coal or aggregate.

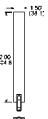

### GRP-25

Stainless steel for very light materials, 3-vane, paddles are 5" tall and 1/16" thick to increase resistance in light materials.

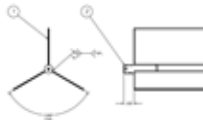

### GRP-26

Direct connect version of GRP-1 for light materials, 3-vane, stainless steel, 7" diameter with blades that are 2" wide (side mounting only).

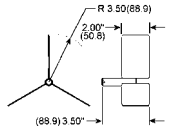

### GRP-27

Direct connect version of GRP-23 paddle for medium materials. Insertable, single bayonet style, stainless steel, blade is 1/8" thick and 1" wide (side mounting only).

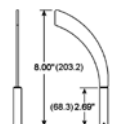

### GRP-28

Stainless steel for extremely light materials, 3-vane, 7" diameter for added resistance, blades are 5" tall and 1/16" thick to increase resistance in light materials.

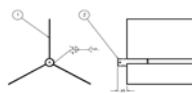

### GRP-29

Direct connect version of GRP-25, 3-vane, stainless steel paddle for very light materials, paddles are 5" tall and 1/16" thick to increase resistance in light materials (side mounting only).

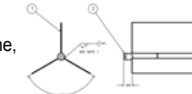

### GRP-30

Direct connect version of GRP-2 for medium materials, 3-vane paddle, stainless steel, turns in 5" diameter, (side mounting only).

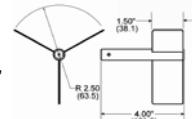

### GRP-31

Stainless steel, single-bladed, 3-1/4" long for heavy materials, turns in 6-1/2" diameter, blade is 1/8" thick and 1.63" wide.



### GRP-34

Stainless steel, single-bladed, direct connect, insertable paddle, folds to insert through a 1-1/4" or 1-1/2" NPT opening, turns in 7-1/2" diameter. Paddle blades are 1-1/2" wide.

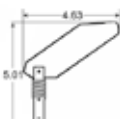

### GRP-35

Stainless steel, double-bladed, direct connect, insertable paddle, folds to insert through a 1-1/4" or 1-1/2" NPT opening, turns in 7-1/2" diameter, paddles blades are 1-1/2" wide.

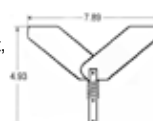

### GRP-36

Stainless steel, single-bladed, threaded, insertable paddle, folds to insert through a 1-1/4" or 1-1/2" NPT opening, turns in 7-1/2" diameter, paddles blades are 1-1/2" wide.

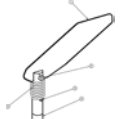

### GRP-37

Stainless steel, double-bladed, threaded, insertable paddle, folds to insert through a 1-1/4" or 1-1/2" NPT opening, turns in 7-1/2" diameter, paddles blades are 1-1/2" wide.

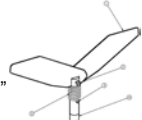



# ROTARY

## Mounting Plates

Mounting plates allow the rotary units to be mounted from the outside of a vessel on a curved or flat surface. A half coupling mounting plate is used in side mount installations. A full coupling mounting plate is for use in top mount installations where a shaft extension and shaft guards are required. Both mounting plates are available in powder coated carbon steel and stainless steel for use in corrosive environments.

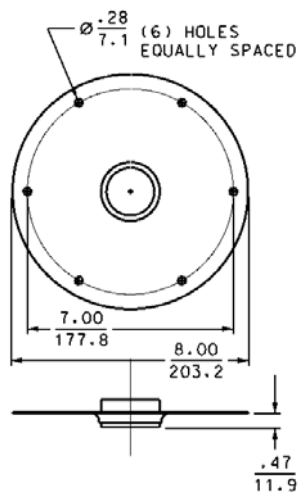

**Half Coupling Mounting Plate**

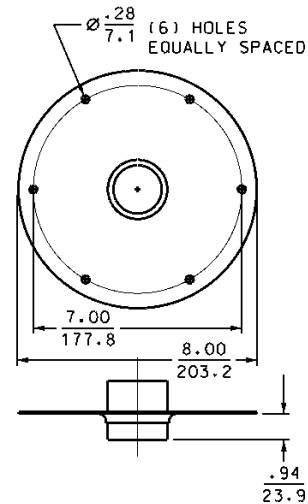

**Full Coupling Mounting Plate**

## Solid Shaft Coupler

A short solid shaft coupler should be used in side mount installations.

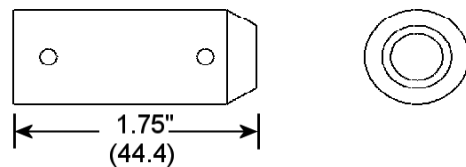

## Flexible Shaft Coupler

The flexible coupler should be used in top mount installations to absorb side loads and protect the internal workings of the unit.

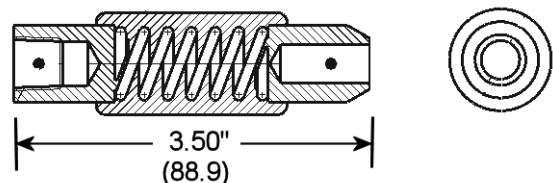

# ROTARY



Vertical  
Mounted  
Flexible  
Hanging  
Rotary  
Extension



# ROTARY

## Pipe Extension Horizontal

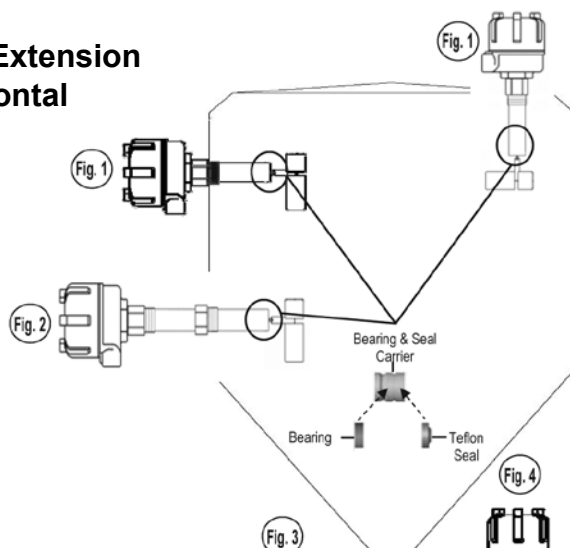

## Pipe Extension Vertical

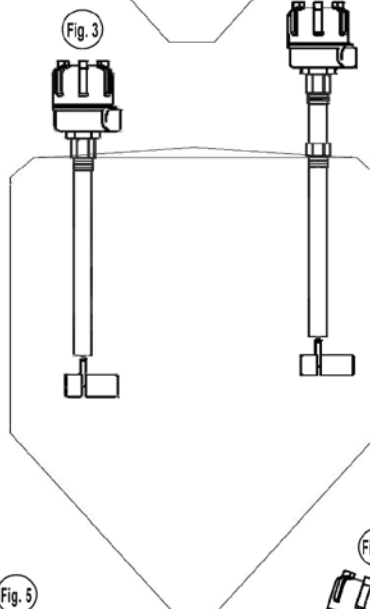

## Pipe Extension Vertical or Angled

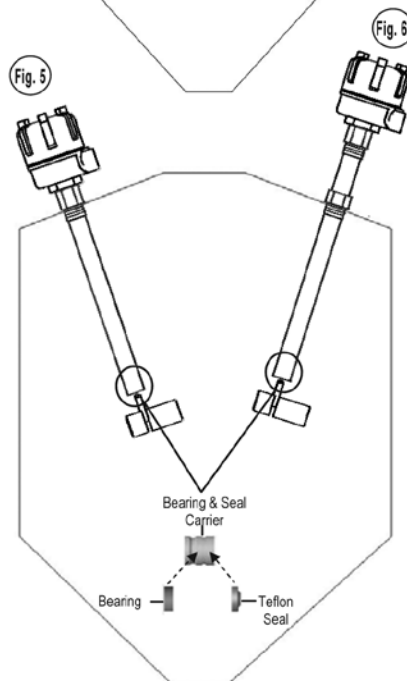

This extension was designed for horizontal applications that need the paddle extended from 6 to 12 inches from the vessel sidewall without compromising any strength. A bearing and shaft seal are at the shaft guard end to center the shaft extension and prevent material from getting up into shaft guard. This unit can also be installed in angled hoppers or vertically from the top. A single vane folding insertable paddle is recommended. This paddle will collapse to fit through a standard 1-1/4" or 1-1/2" process connection from outside the vessel, eliminating the need to cut large holes or go into the vessel. A heat tube is available for high temperature applications.

This extension was designed to extend vertically with a 1" shaft guard and 1/4" shaft extension. The shaft guard is coupled directly into the process connection so it can be mounted without having to use a full coupling mounting plate. A double vane folding insertable paddle is recommended. This paddle will collapse to fit through a standard 1-1/4" or 1-1/2" process connection from outside the vessel, eliminating the need to cut large holes or gain access into the vessel. It also allows you to simply drop in a rotary where another kind of technology may not be working well in your application. A heat tube is available for high temperature applications.

This extension was designed for angled vertical applications. A bearing and shaft seal are at the shaft guard end to center the shaft extension and prevent material from getting up into shaft guard. The shaft guard is coupled directly into the process connection so it can be mounted without having to use a full coupling mounting plate. A double or single vane folding insertable paddle is recommended. This paddle will collapse to fit through a standard 1-1/4" or 1-1/2" process connection from outside the vessel, eliminating the need to cut large holes or gain access into the vessel. A heat tube is available for high temperature applications.

# ROTARY

Fig. 1

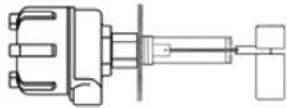

## **Extended Horizontal or Vertical Mounted Rotary *with* Seal and Bearing at Tube End**

Extended rotary with 1" protection tube for vertical, horizontal and angled installations. Comes in 6", 8", 10", or 12" fixed insertion lengths.

Fig. 2

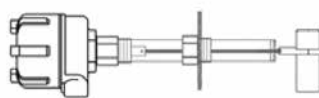

## **Extended Horizontal or Vertical Mounted Rotary *with* Seal and Bearing at Tube End and Heat Tube**

Extended rotary with 1" protection tube and heat tube for high temp. vertical, horizontal and angled installations. Heat tube comes in 8" or 12" lengths. Protection tube comes in 6", 8", 10" or 12" fixed insertion lengths.

Fig. 3



## **Coupled Extended Vertical Mounted Rotary *without* Seal and Bearing at Tube End**

Extended rotary with 1" shaft guard for straight vertical installations. The shaft guard is coupled directly into the process connection so it can be inserted through a 1-1/4" or 1-1/2" fitting.

Fig. 4



## **Coupled Extended Vertical Mounted Rotary *without* Seal and Bearing at Tube End and Heat Tube**

Extended rotary with 1" shaft guard and heat tube for high temp. Straight vertical installations. The shaft guard is coupled directly into the process connection so it can be inserted through a 1-1/4" or 1-1/2" fitting.

Fig. 5



## **Coupled Extended Vertical Mounted Rotary *with* Seal and Bearing at Tube End**

Extended rotary with 1" shaft guard for straight vertical and angled installations. The shaft guard is coupled directly into the process connection so it can be inserted through a 1-1/4" or 1-1/2" fitting.

Fig. 6

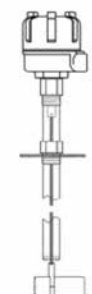

## **Coupled Extended Vertical Mounted Rotary *with* Seal and Bearing at Tube End and Heat Tube**

Extended rotary with 1" protection tube and heat tube for high temp. Straight vertical and angled installations. The shaft guard is coupled directly into the process connection so it can be inserted through a 1-1/4" or 1-1/2" fitting.

# ROTARY

## Bearing and Viton Seal at Tube End

The bearing and Viton seal are used to keep the shaft centered and turning without restraint when mounting from the top of a vessel at an angle, or horizontally. It also seals the shaft guard so no material can be forced up into the pipe. The bearing and Viton seal can operate in temperatures up to 500°F (260°C).

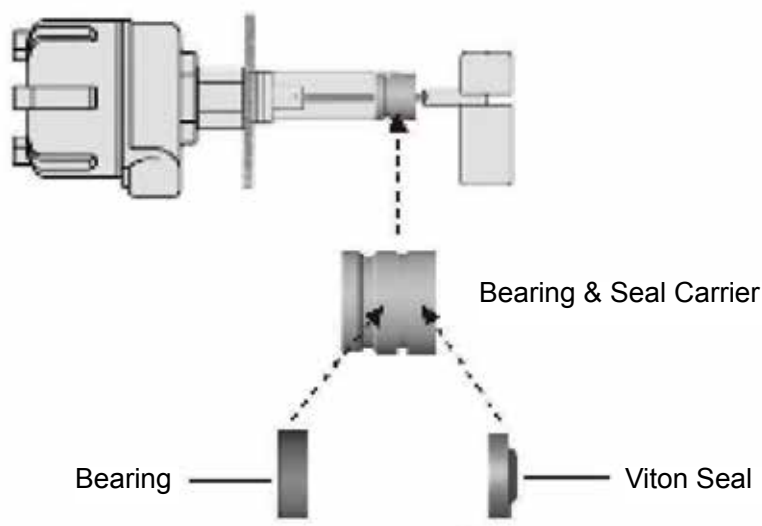

## Bearing and Teflon Seal at Tube End

The bearing and Teflon seal are used to keep the shaft centered and turning without restraint when mounting from the top of a vessel at an angle, or horizontally. It also seals the shaft guard so no material can be forced up into the pipe. The bearing and Teflon seal can operate in temperatures up to 500°F (260°C).

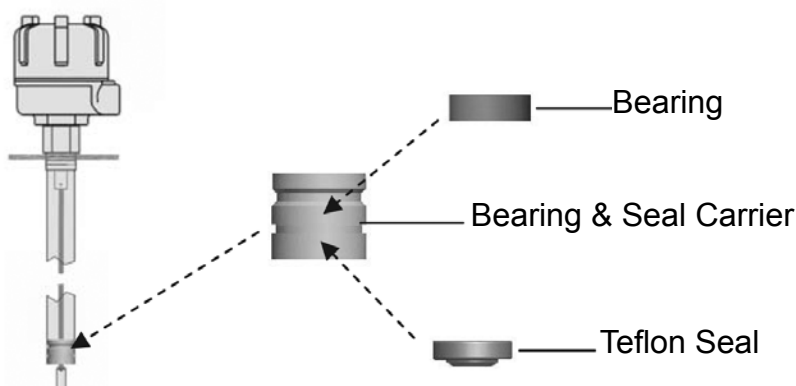

# ROTARY - MINI

ORDER CODE	DESCRIPTION	LIST PRICE	PART NUMBER
<b>MINI-ROTARY COMPLETE UNITS</b>			
<b>MR-G-110</b>	MR-G-110 - Mini-Rotary with 4-vane, polycarbonate paddle, complete with SPDT contacts	Call for price	730-0350
<b>MR-G-220</b>	MR-G-220 - Mini-Rotary with 4-vane, polycarbonate paddle, complete with SPDT contacts	Call for price	730-0352
<b>MR-G-24</b>	MR-G-24 - Mini-Rotary with 4-vane, polycarbonate paddle, complete with SPDT contacts	Call for price	730-0392
<b>MR-H-100</b>	MR-H-110 - Mini-Rotary with insertable bayonet polycarbonate paddle, complete with SPDT contacts	Call for price	730-0351
<b>MR-H-220</b>	MR-H-220 - Mini-Rotary with insertable bayonet polycarbonate paddle, complete with SPDT contacts	Call for price	730-0353
<b>MR-I-100</b>	MR-I-110 - Mini-Rotary with single-vane, stainless steel rectangular paddle, complete with SPDT contacts	Call for price	730-0354
<b>MR-I-220</b>	MR-I-220 - Mini-Rotary with single-vane, stainless steel rectangular paddle, complete with SPDT contacts	Call for price	730-0355
<b>MINI-ROTARY PADDLES &amp; ACCESSORIES</b>			
<b>G</b>	Mini-Rotary 4-vane, polycarbonate paddle turns in a 3.2" diameter, paddle blades are 1.25" wide	Call for price	299-0936
<b>H</b>	Mini-Rotary insertable bayonet polycarbonate paddle, turns in a 5" diameter	Call for price	299-0937
<b>I</b>	Mini-Rotary single-vane, stainless steel rectangular paddle turns in a 4" diameter, paddle blades are 1.2" wide	Call for price	299-0938